

Take a really good look

Telescopic Trailer Tow Mirror by  **scheffenacker**

take a really good look

Replacement Component Installation Instructions

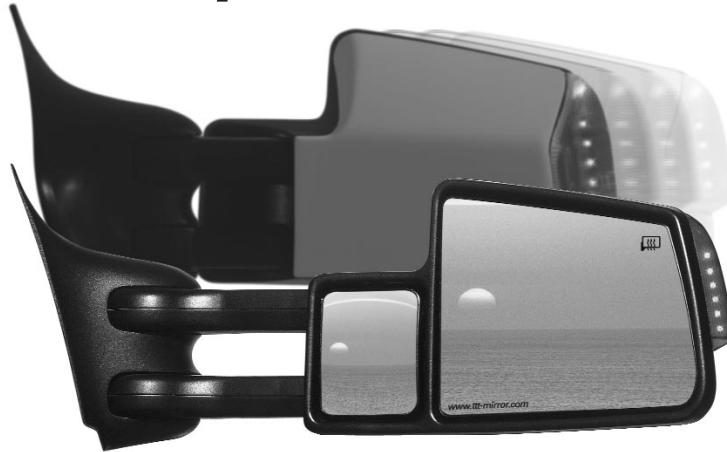

Part # 1440373
Version # B
Issued 17 Mar 05

Important Information

All illustrations are drawn to show driver's side component.

WARNING

Please read ALL the instructions and warnings thoroughly before installing the replacement parts. Ensure that the fitting instructions are followed exactly, as failure to do so may result in incorrect installation, and may also result in the driver, passengers and vehicle being placed in hazardous conditions.

Scheffenacker Warranty – Terms & Conditions

Scheffenacker Vision Systems Australia Pty Ltd warrants that this component is free from defects in material and workmanship under normal use for a period of 12 months from the date of purchase.

STEP 1

MAIN GLASS REPLACEMENT (part # 9020 - 9023)

Existing glass removal.

Make sure you have the required tools:

- **slotted screwdriver.**

Approximate installation time: 10 minutes.

WARNING: Take care when dealing with all glass products, especially broken glass.

1. Angle back the top edge of the main glass as far as practical and insert the tip of the screwdriver into the slot of the mirror glass mounting as per Figure 1.

Twist the screwdriver, levering off the main glass.

CAUTION: Heated main glass with the  symbol will have two wires attached to the rear of the main glass.

Continued over page...

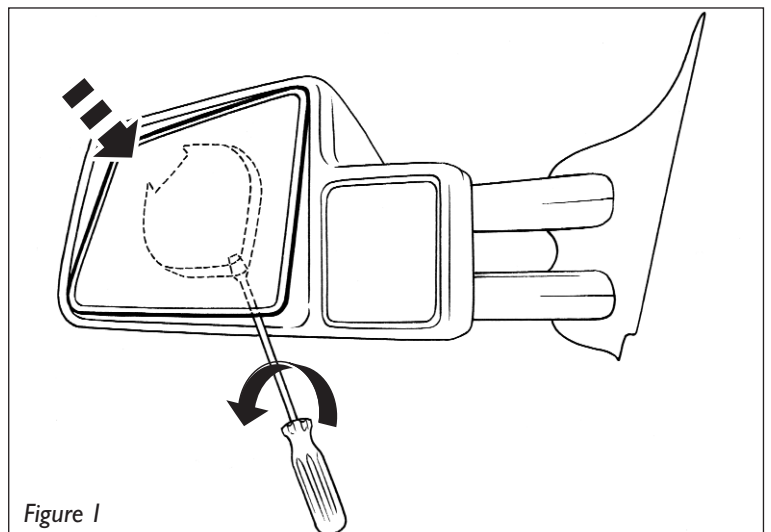

Figure 1

2. Identify your mirror model:

If Damper Spring Slides are not fitted, discard the supplied Damper Springs and proceed to Step 4.

If Damper Spring Slides are fitted, then fit the supplied Damper Springs as per Step 3.

(see Figure 2a and 2b opposite)

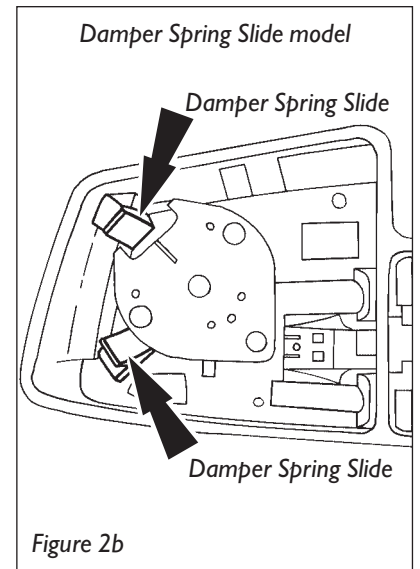
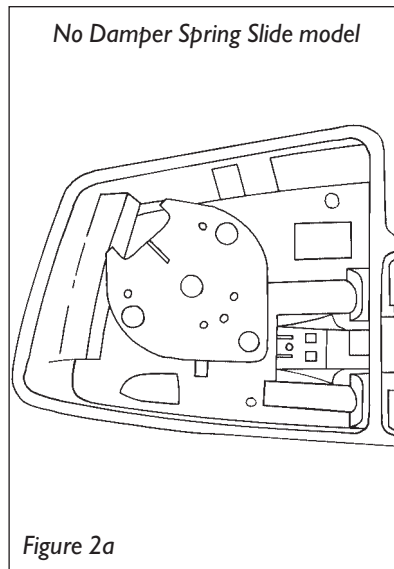

3. Push the supplied Damper Springs into the Damper Spring Mount Brackets on the new mirror back until securely located.

(see Figure 3 opposite)

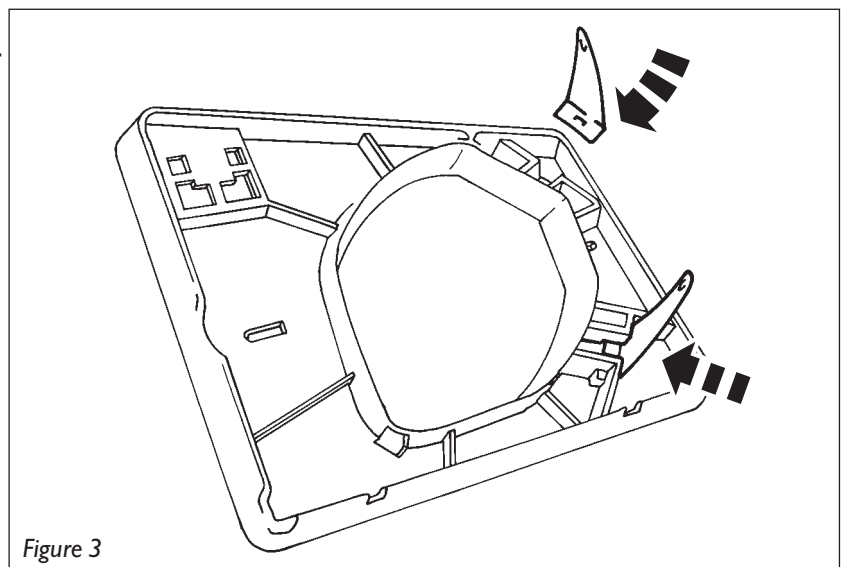

4. If the main glass is the heated kind, remove the two wires from the back of the glass, and refit the wires to the replacement main glass.

If Damper Spring Slides are not fitted, proceed to Step 6.

(see Figure 4 opposite)

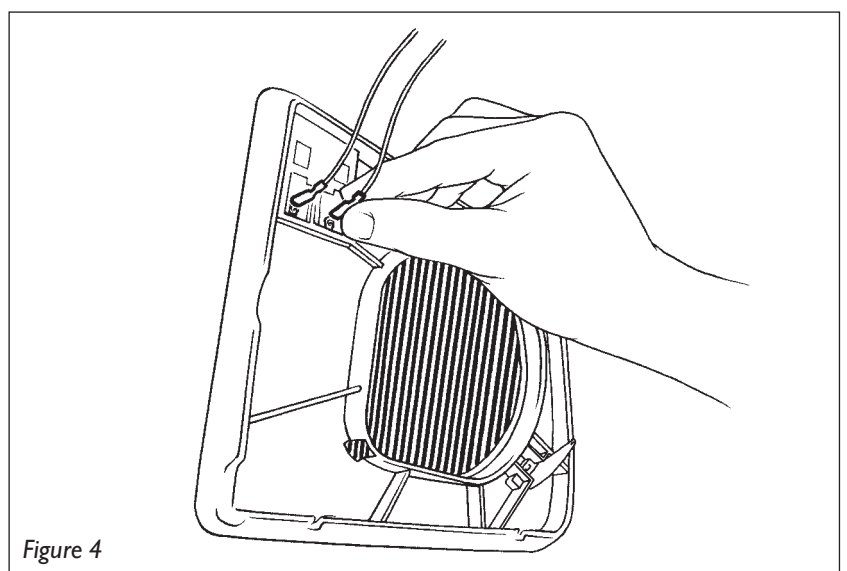

5. If Damper Spring Slides are fitted, refit main glass by positioning the replacement glass centrally over the motor mechanism, ensuring that the Damper Springs sit on the inner surface of the Damper Spring Slides.
(see Figure 5 opposite)

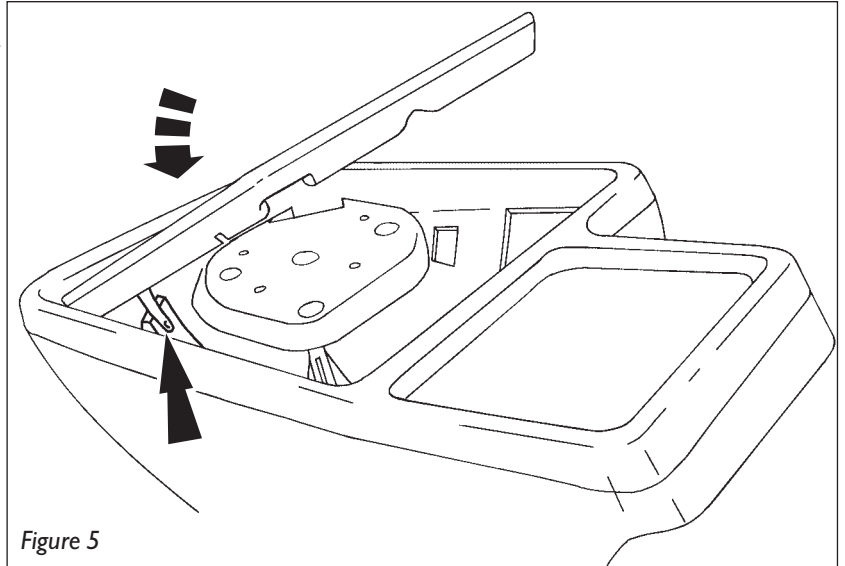

Figure 5

6. With the replacement glass positioned centrally over the motor mechanism, push each corner of the main glass in turn until securely located. Check for even fit and smooth movement of your replacement part.
(see Figure 6 opposite)

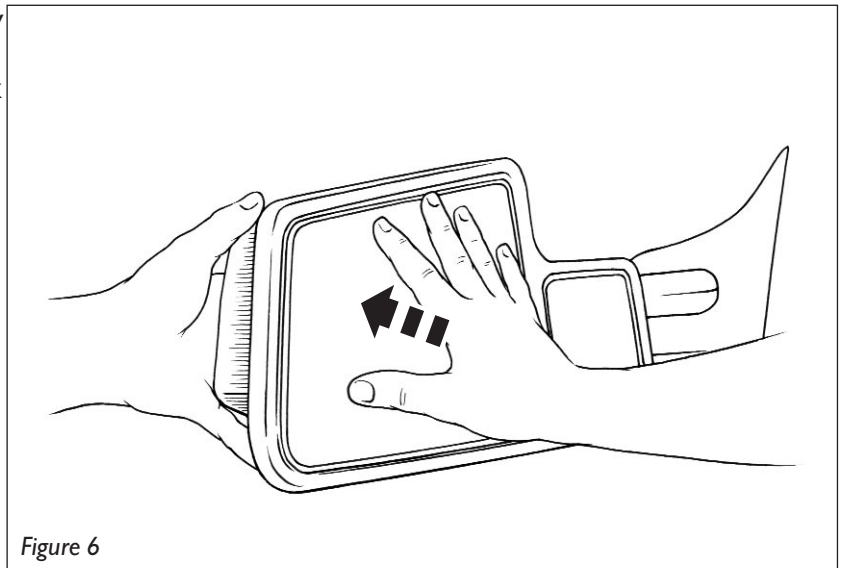

Figure 6